

# MOTORI PER ASPIRAPOLVERE - ASPIRALIQUIDI BY-PASS

## BY-PASS MOTORS FOR VACUUM-CLEANERS AND LIQUID ASPIRATORS

### CARATTERISTICHE TECNICHE:

Esecuzione con due cuscinetti a sfere.  
 Due impedenze antidisturbo radio.  
 Classe di isolamento B Grado II.  
 Motore monofase 230V 50/60 Hz  
 Costruzione conforme alle norme CE.

### TECHNICAL CHARACTERISTICS:

Execution with two ball bearings.  
 Two radio antijamming impedances.  
 Insulation class B Degree II.  
 230V 50/60 Hz single-phase motor.  
 CE norms.

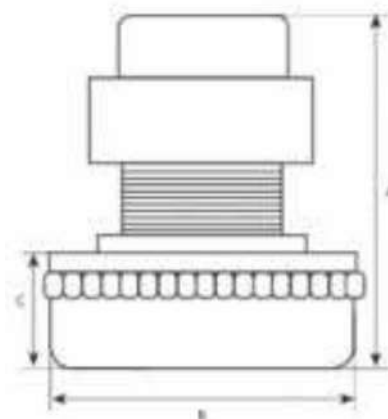

Articolo Art.	Potenza max W Max power W	A	Ø B	C	Stadi Stages
<b>ASP. 910</b>	1000	168	144	69	2
<b>ASP. 911</b>	1200	176	144	69	2
<b>ASP. 610</b>	1000	168	144	66.5	2
<b>ASP. 611</b>	1200	176	144	66.5	2



Articolo Art.	Potenza max W Max power W	A	Ø B	C	Stadi Stages
<b>ASP. 502</b>	1000	168	144	69	2
<b>ASP. 504</b>	1200	170	144	69	2



Articolo Art.	Potenza max W Max power W	A	Ø B	C	Stadi Stages
<b>ASP. 612</b>	1200	203	144	92.5	3
<b>ASP. 613</b>	1500	205	144	92.5	3