

TENUTE MECCANICHE

MECHANICAL SEALS

BURGMANN



È possibile accoppiare queste tenute con le controfaccie a normativa DIN 24960 - EN12756 serie CA. 300 illustrate a pag. 71. Le controfaccie sono fornibili a parte.

These seals can be coupled to the DIN 24960 - EN12756 counterfaces series CA 300 illustrated on page. 71. The counterfaces are supplied separately.

TENUTA

Corpo tenuta in acciaio AISI 304 e ceramica.
Molla in acciaio AISI 316 - Guarnizioni in gomma nitrile.

Seal

Seal body in AISI 304 steel and ceramic.
Spring in AISI 316 steel - Nitrile rubber gaskets.

CONTROFACCIA

Carbone sintetico - Guarnizioni in gomma nitrile.

Counterface

Synthetic carbon - Nitrile rubber gaskets.

APPLICAZIONE

Tenuta meccanica a senso di rotazione dipendente (di serie con molla destra) di grande impiego per pompe nel settore industriale e per uso domestico.

Application

Mechanical seal with dependent rotation direction (standard with right spring) widely used for pumps in the industry and for domestic use.

LIMITI D'IMPIEGO

$p = 10 \text{ atm} - t = -20^\circ\text{C} \div + 90^\circ\text{C} - v = 20 \text{ m/s.}$

Limits of use

$p = 10 \text{ atm} - t = -20^\circ\text{C} \div + 90^\circ\text{C} - v = 20 \text{ m/s.}$

SERIE / SERIES RT

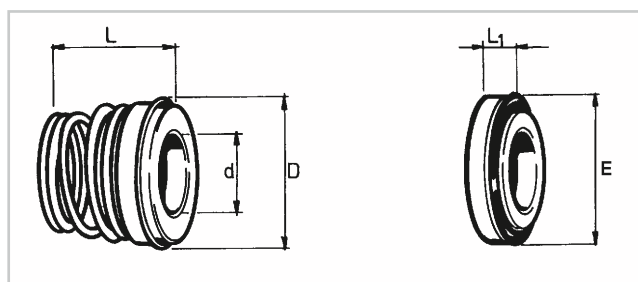

Tenuta completa di controfaccia /
Seal complete with counterface

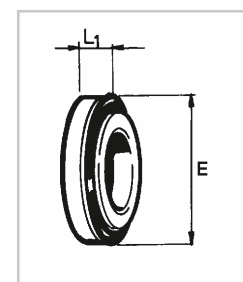

Solo controfaccia / Counterface only

Articolo Art.	d Ø Albero d Ø Shaft	D	L Lung. lavoro L Working length	E	L ₁
RT.302	10	19.5	15	18.1	5.5
RT.303	12	22.5	18	20.6	5.5
RT.304	13	24.5	22	23.1	6
RT.305	14	24.5	22	23.1	6
RT.306	15	29	22	26.9	7
RT.307	16	29	23	26.9	7
RT.308	17	29	23	26.9	7
RT.309	18	32.5	24	30.9	8
RT.310	19	32.5	25	30.9	8
RT.311	20	32.5	25	30.9	8
RT.312	22	37.5	25	35.4	8
RT.313	24	37.5	27	35.4	8
RT.314	25	40	27	38.2	8.5
RT.315	28	46	29	43.3	9
RT.316	30	46	30	43.3	9
RT.317	32	46	30	43.3	9
RT.318	35	50	39	53.5	11.5
RT.319	38	58	39	60.5	11.5
RT.320	40	58	39	60.5	11.5

Articolo Art.	d Ø Albero d Ø Shaft	E	L ₁
CA.262	10	18.1	5.5
CA.264	12	20.6	5.5
CA.265	13	23.1	6
CA.266	14	23.1	6
CA.267	15	26.9	7
CA.268	16	26.9	7
CA.269	17	26.9	7
CA.270	18	30.9	8
CA.271	19	30.9	8
CA.272	20	30.9	8
CA.274	22	35.4	8
CA.276	24	35.4	8
CA.277	25	38.2	8.5
CA.280	28	43.3	9
CA.282	30	43.3	9
CA.283	32	43.3	9
CA.286	35	53.5	11.5
CA.289	38	60.5	11.5
CA.291	40	60.5	11.5